

# A REQUEST FOR PROPOSAL FOR PROFESSIONAL SERVICES CONTRACT

Department of Highways  
Professional Services Procurement Bulletin 2022-02  
Calloway | 1-8952 | KY-748 & CS-1047

This document constitutes a Request for Proposals for a Professional Service Contract from qualified individuals and organizations to furnish those services as described herein for the Commonwealth of Kentucky, Department of Highways.

## **I. PROJECT DESCRIPTION**

County - Calloway  
Route - KY-748 / CS-1047  
Item No. - 1-8952.00  
Project Description - Improve North 16th street from KY 1327 (5 points) to KY 121

## **II. PROJECT INFORMATION**

Project Manager - James Tilley, P.E.  
User Division - Highway Design  
Approximate Fee - \$300,000 Preliminary Engineering & Environmental Services (Lump Sum)  
Project Funding - State Funds (SPP Funds)  
Project Length - Approximately 0.69 miles

## **III. PURPOSE AND NEED**

The purpose of this project is to improve safety, mobility and traffic flow as well as facilitate bicycle and pedestrian movements to and from the campus. Project goals include the potential to enhance the visual aesthetics of this alternate route to Murray State University.

This short route, KY-748 and CS-1047, serves as a direct connector to and from Murray State University. It is a daily commuting route for local residents and students. The campus and city are a pro walk/bike community, and the potential for improvements on this route would be compatible with a multimodal vision. North 16th Street provides commuters with an alternate route for the primary routes in the area, US-641 and KY-80. Due to North 16th Street's current geometrics with heavy peak hour movements, the route is congested and difficult to maneuver at times.

## **IV. DBE REQUIREMENT**

None

## **V. SCOPE OF WORK**

The selected Consultant will be required to provide Preliminary Roadway design and Environmental Services, including the preparation of engineering studies, identification of appropriate typical sections, identifying any utility impacts, performing drainage design, developing dependable cost estimates, and conducting and preparing documents for public meetings.

This project may be advanced to Final Design upon the completion of Preliminary Engineering with a Contract Modification. The selected Consultant will then be required to provide engineering services to perform Final Roadway and Structural Design, including the preparation of any design studies, drainage design, right-of-way plans, construction plans, traffic control plans, and cost estimates as well as any other services that KYTC chooses not to perform with in-house forces.

## **VI. SPECIAL INSTRUCTIONS**

The Department may retain any of the advertised services to be performed by in-house state forces.

Instructions for Response to Announcement can be found at:

<https://transportation.ky.gov/ProfessionalServices/Pages/Respond-to-an-Announcement.aspx>

## **VII. AVAILABLE STUDIES**

[DNA Study – Calloway | 1-8952 | KY-748 & CS-1047](#)

[Alt Intersections at KY-1327 - Calloway | 1-8952 | KY-748 & CS-1047](#)

[Murray Comp Plan 2009 - Calloway | 1-8952 | KY-748 & CS-1047](#)

## **VIII. METHOD OF DESIGN**

The selected Consultant shall utilize the most recent CADD Standards for Highway Plans Policy in the development of the highway plans. Refer to the 2019 CADD Standards for ORD V4 Project Development Memo for information pertaining to the latest CADD Standards and plan submittal.

## **IX. ENVIRONMENTAL SERVICES**

KYTC will retain the environmental services that aren't listed in Section XV. Prequalification Requirements. Any necessary Environmental Services are expected to be provided by the Consultant. The anticipated environmental document will be a Categorical Exclusion Level 1. Prequalification of various Environmental Services are required to be identified in the Consultant's Response to Announcement. The selected Consultant will perform studies needed to ascertain the potential for obtaining environmental documents in a future phase.

## **X. PHOTOGRAMMETRIC SERVICES**

The Department will provide LiDAR digital mapping and will furnish manuscripts on computer

disks in DGN format. The selected Consultant shall supplement this information with conventional surveying as needed.

## **XI. STRUCTURE DESIGN**

Structure Design is not anticipated for this project. However, if structure design is needed when the project advances to Final Design and if the selected Consultant is retained for Final Design services, the selected Consultant shall do the necessary engineering services to submit to the KYTC an Advanced Situation Folder(s) for the appropriate structure(s). The selected Consultant may be responsible for any necessary Structure Design services. Structure Design of the proposed structure(s) may be added as a Contract Modification. Prequalification in the area of Structure Design is not required to be identified in the Consultant's Response to Announcement; however, the selected Consultant must obtain the required qualifications before providing these services, or bring a prequalified subconsultant at that time.

## **XII. GEOTECHNICAL SERVICES**

The Department is expected to provide all Geotechnical Services but the selected Consultant may be asked to provide Geotechnical Services required for the project. The Preliminary Design contract may include preliminary geotechnical services to review available geological, mining, or other geotechnical information that could influence the selection of the preferred alternate. Geotechnical services necessary for the completion of Final Design may be added by contract modification at the appropriate time. At any time, if the Department has the capacity to provide these services, the Department may retain the advertised geotechnical services. Prequalification in the area of Geotechnical Services is not required to be identified in the Consultant's Response to Announcement; however, the selected Consultant must obtain the required qualifications before providing these services, or bring a prequalified subconsultant at that time.

## **XIII. TRAFFIC ENGINEERING**

The selected Consultant will provide the analysis of the existing and proposed operations. Traffic Signal Design and Lighting Design services, if necessary for the completion of Final Design, may be added by Contract Modification at the appropriate time. At any time, if the Department has the capacity to provide these services, the Department may retain the advertised traffic services.

## **XIV. UTILITIES**

The Department will be responsible for determining the existing locations of utilities to determine feasibility of redesign or utility relocation and cost estimates.

## **XV. PREQUALIFICATION REQUIREMENTS**

To respond to this project the Consultant must be prequalified in the following areas by the response due date of this advertisement:

### [Environmental Archeology & Other Services](#)

- Air Quality Analysis
- Socio-Economic Analysis

- Highway Noise Analysis
- Historic Archaeology
- Cultural-Historic Analysis

#### Roadway Design

- Rural Roadway Design
- Advanced Traffic Engineering Design & Modeling
- Surveying
- Urban Roadway Design
- *Advanced Drainage Analysis & Design\** (please see note below)

#### Traffic Engineering

- Traffic Engineering
- *Electrical Engineering Roadway Lighting\** (please see note below)
- *Electrical Engineering Traffic Signals\** (please see note below)

#### Transportation Planning

- ~~Traffic Forecasting~~ *Traffic Forecasting\**
- Traffic Data Collection
- Pedestrian & Bicycle Planning & Design
- *Advanced Transportation Planning Engineering\** (please see note below)
- *Travel Demand & Simulation Modeling\** (please see note below)

#### Geotechnical Services (please see note below)

- *Geotechnical Engineering\**
- *Geotechnical Drilling\**
- *Geotechnical Laboratory Testing\**

#### Structure Design (please see note below)

- *Spans Under 500 Feet\**

#### Utility Design (please see note below)

- *Utility Preconstruction Coordination\**

\* Note – *Advanced Drainage Analysis & Design, Electrical Engineering Roadway Lighting, Electrical Engineering Traffic Signals, **Traffic Forecasting**, Advanced Transportation Planning Engineering, Travel Demand & Simulation Modeling, Geotechnical Services, Structure Design, and Utility Design prequalifications are not required with the initial proposal as it is uncertain to the extent practicable if they are necessary. Should these services become necessary during the delivery of the project in this or future phases, the selected Consultant team must obtain the required qualifications before providing those services, or bring on a prequalified subconsultant at that time.*

## **XVI. PROCUREMENT SCHEDULE**

Dates other than Response Date are tentative and provided for information only.

- Advertisement Date: August 10, 2021
- Response Date: September 1, 2021 by 4:30 PM ET (Frankfort Time)
- First Selection: September 7, 2021
- Final Selection: September 22, 2021
- Pre-Design Conference: September 29, 2021

- Consultant Fee Proposal: October 8, 2021
- Contract Negotiations: October 20, 2021
- Notice To Proceed: November 10, 2021

**XVII. PROJECT SCHEDULE**

- Preliminary Line and Grade Meeting – May 2022
- Submit Design Executive Summary – June 2022

**XVIII. EVALUATION FACTORS**

Consultants will be evaluated by the selection committee based on the following, weighted factors:

1. Project approach and proposed procedures to accomplish the services for the project. (20 Points)
2. Relative experience of consultant personnel assigned to project team with highway project for KYTC and/or federal, local or other state governmental agencies. (15 Points)
3. Past record of performance on projects similar in type and complexity. (15 Points)
4. Capacity to comply with project schedule. (10 Points)
5. Knowledge of the locality and familiarity of the general geographic area. (2 Points)

**XIX. SELECTION COMMITTEE MEMBERS**

1. James Tilley, P.E., User Division
2. Patrick Perry, P.E., User Division
3. Charlie Dale, P.E., Secretary's Pool
4. Stephen De Witte, P.E., Secretary's Pool
5. John Greenwell, P.E., Governor's Pool

**XX. AREA MAP**

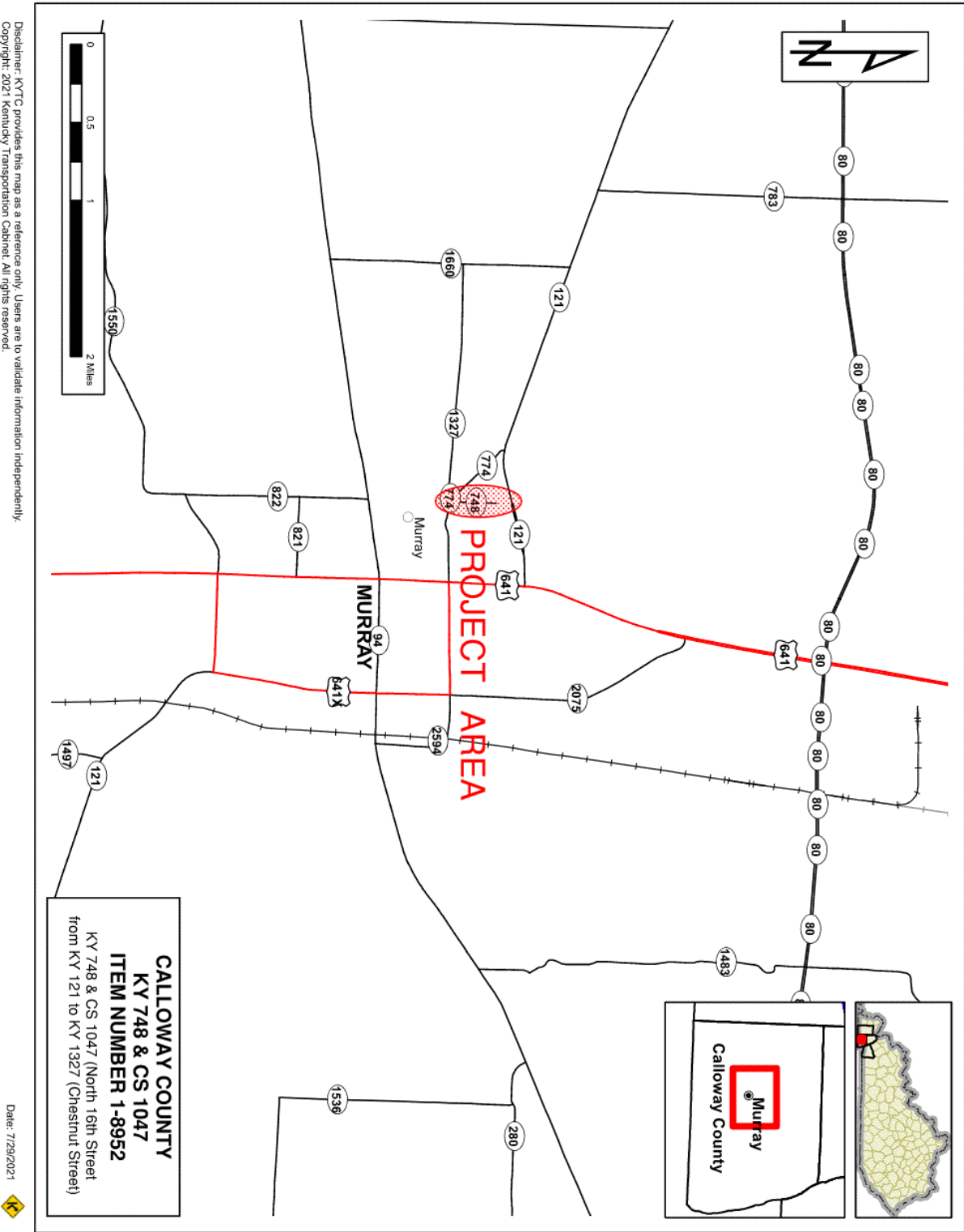

Disclaimer: KYTC provides this map as a reference only. Users are to validate information independently.  
 Copyright: 2021 Kentucky Transportation Cabinet. All rights reserved.